

# ULTRA VIOLET LED Lamp SMD Type NS400L-4SFH

## (1) Absolute Maximum Ratings (Ta=25°C)

Item	Symbol	Maximum Rating	Unit
DC Forward Current	$I_F$	100	mA
Power Dissipation	$P_D$	840	mW
Operating Temperature	$T_{OPR}$	-30 to +80	°C
Storage Temperature	$T_{STG}$	-30 to +100	°C

## (2) Dimension (Unit : mm) tolerance $\pm 0.20$

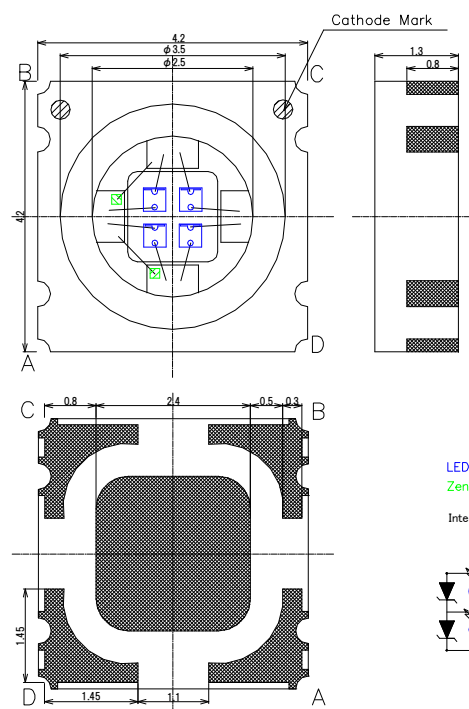

## (3) Recommended Soldering Pattern tolerance $\pm 0.20$

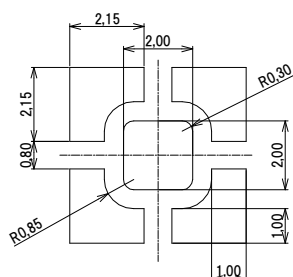

## (4) Optical and Electrical Characteristics (Ta=25°C)

Item	Symbol	Condition	Min.	Typ.	Max.	Unit
Forward Voltage	$V_F$	$I_F=80\text{mA}$	6.4	6.8	8.4	V
Peak Wavelength*1	$\lambda_p$	$I_F=80\text{mA}$	400	-	405	nm
Full Width at Half Maximum	$\Delta\lambda$	$I_F=80\text{mA}$	10	-	20	nm
Optical Output Power*2	$P_o$	$I_F=80\text{mA}$	-	150	-	mW

\*1 Measurement error is  $\pm 2\text{nm}$ \*2 Measurement error is  $\pm 10\%$ 

## (5) Directive Characteristics (Ta=25°C)

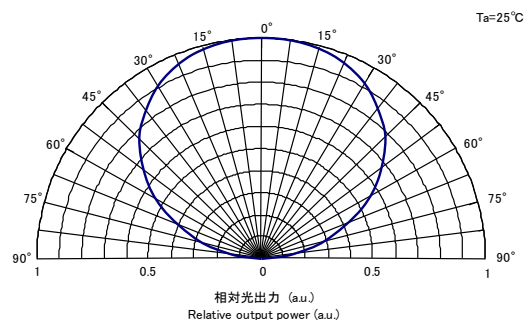

### CAUTION

- LEDs emit very strong UV radiation.
- Don't look directly into the LED light. UV radiation can harm your eyes.
- To prevent even inadequate exposure, wear protective eyewear.
- If LEDs are embedded in devices, please indicate warning labels against the UV light LED used.
- Keep out of reach of children.

Specification and dimension are subject to change for improvement without notice.