

ULTRA VIOLET LED Lamp SMD Type NS375L-4SFG

(1) Absolute Maximum Ratings (Ta=25)

Item	Symbol	Maximum Rating	Unit
DC Forward Current	I_F	150	mA
Power Dissipation	P_D	630	mW
Operating Temperature	T_{OPR}	-30 to +80	
Storage Temperature	T_{STG}	-30 to +85	

(3) Recommended Soldering Pattern tolerance ± 0.20

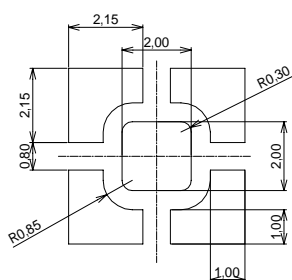

(2) Dimension (Unit : mm) tolerance ± 0.20

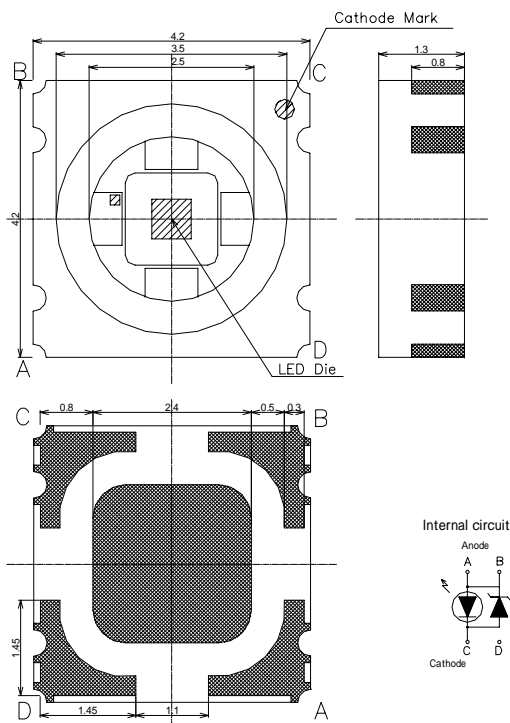

(4) Optical and Electrical Characteristics (Ta=25)

Item	Symbol	Condition	Min.	Typ.	Max.	Unit
Forward Voltage	V_F	$I_F=100\text{mA}$	3.2	3.5	4.6	V
Peak Wavelength*1	λ_p	$I_F=100\text{mA}$	375	-	380	nm
Full Width at Half Maximum	$\Delta\lambda$	$I_F=100\text{mA}$	10	-	20	nm
Optical Output Power *2	P_o	$I_F=100\text{mA}$	-	48.0	-	mW

*1 Measurement error is $\pm 2\text{nm}$ *2 Measurement error is $\pm 10\%$

(5) Directive Characteristics (Ta=25)

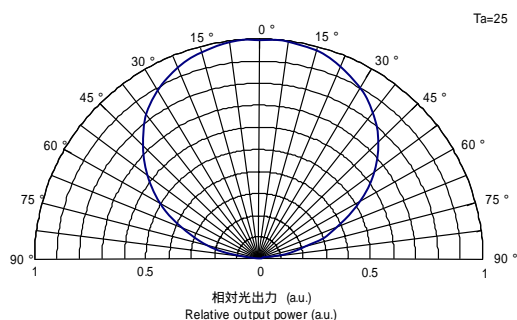

CAUTION

- LEDs emit very strong UV radiation.
- Don't look directly into the LED light. UV radiation can harm your eyes.
- To prevent even inadequate exposure, wear protective eyewear.
- If LEDs are embedded in devices, please indicate warning labels against the UV light LED used.
- Keep out of reach of children.

Specification and dimension are subject to change for improvement without notice.